

Spedo Outfeed Accelerator 953

OPERATORS MANUAL

Issue 4

Part Number SP004 703

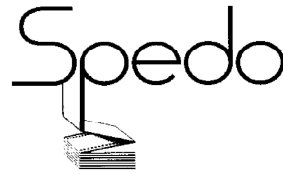

Unit 5, Riverwey Ind. Park
Newman Lane
Alton
Hampshire GU34 2QL
ENGLAND

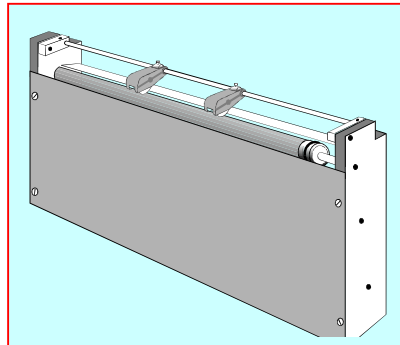

Telephone

National: 01420 86546

International: +44 1420 86546

Facsimile

National: 01420 89892

International: +44 1420 89892

Spedo Outfeed Accelerator 953

Copyright

Published by Spedo UK Limited
Unit 5, Riverwey Ind. Park
Newman Lane
Alton,
Hampshire GU34 2QL
ENGLAND

Copyright

Spedo UK Limited 1996

All Rights Reserved.

No part of this publication may be reproduced, stored in a retrieval system, or transmitted, in any form or by any means, electronic, mechanical, photocopying, recording, or otherwise, without the prior written permission of Spedo UK Limited.

Unpack

Unpack the equipment and examine it thoroughly to ascertain whether any damage has occurred in transit. Report immediately any such damage to the agent or manufacturer. Retain the packing should further transportation be necessary.

All Goods

All goods manufactured by the Company are guaranteed to the extent hereafter mentioned against defects arising from faulty material or workmanship subject to the goods not having suffered maltreatment or interference. The Company's liability under this guarantee is limited to replacing any part or parts found defective within a period as laid down in Company instructions after the date of delivery or installation.

Other Goods

If goods not of the Company's manufacture are ordered, the guarantee of that company is to be accepted.

Descriptive Matter

Descriptive matter, illustrations, dimensions and weights issued by the Company are typical and shall not be held as binding.

Patterns and Designs

The Company reserves the right to alter patterns and designs without notice.

First Published September 1996

We have taken every care in the preparation of this manual. If there are any inaccuracies, ambiguities or omissions, Spedo UK Limited and its consultants and distributors cannot accept responsibility for any loss or damage these errors may cause.

Spedo Outfeed Accelerator 953

Safety Measures

This instruction manual contains certain WARNING and CAUTION notices which must be followed by the user to ensure safe operation and to retain the equipment in a SAFE condition.

All users of the equipment described in this manual MUST have received adequate training in its use and application in order to ensure SAFE AND PROPER USE.

Any adjustment, maintenance or repair of the opened apparatus under voltage shall be carried out only by a skilled person who is AWARE OF THE HAZARD INVOLVED.

Spedo Outfeed Accelerator 953

Table of Contents

History Sheet	2
Copyright.....	3
Safety Measures.....	4
Table of Contents.....	5

DESCRIPTION & OPERATION

SECTION 1

INTRODUCTION	6
TECHNICAL DATA.....	6
DESCRIPTION OF OPERATION.....	7
Outfeed Accelerator Unit.....	7
Operation with an Ancillary Unit.....	7
INSTALLATION	8
OPERATING INSTRUCTIONS.....	8
OPERATIONAL MAINTENANCE.....	8

DESCRIPTION & OPERATION

SECTION 1

INTRODUCTION

Outfeed Accelerator Unit 953 is designed to feed forms at an accelerated rate from a Spedo or Bowe guillotine into on-line ancillary equipment, speed folders and conveyor stackers etc.

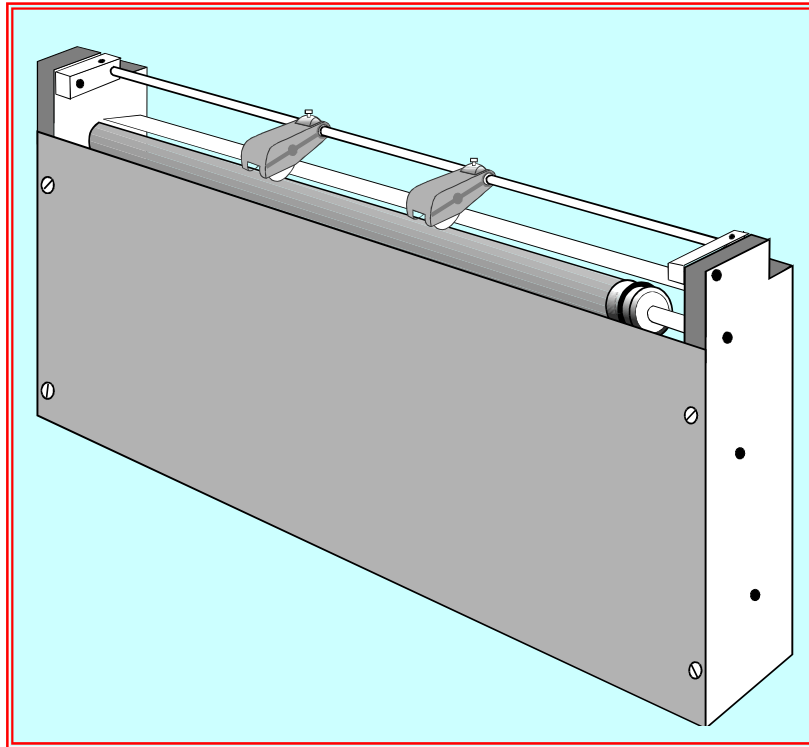

Fig 2.1 Outfeed Accelerator 953

TECHNICAL DATA

Paper Size

Minimum Form Length: 102 mm (4 in)

Maximum Form Length: unlimited

Capacity

800 feet per minute

Mains Power

220 V to 240 V, 50 Hz.

Weight & Dimensions

Length: 643 mm

Width: 101 mm

Height: 285 mm

Weight: 9.5 kg (approx.)

DESCRIPTION OF OPERATION

Outfeed Accelerator Unit

The unit has been manufactured to withstand heavy applications and has been designed to have a long life. It consists of a roller, driven by an electric motor, under the control of a guillotine.

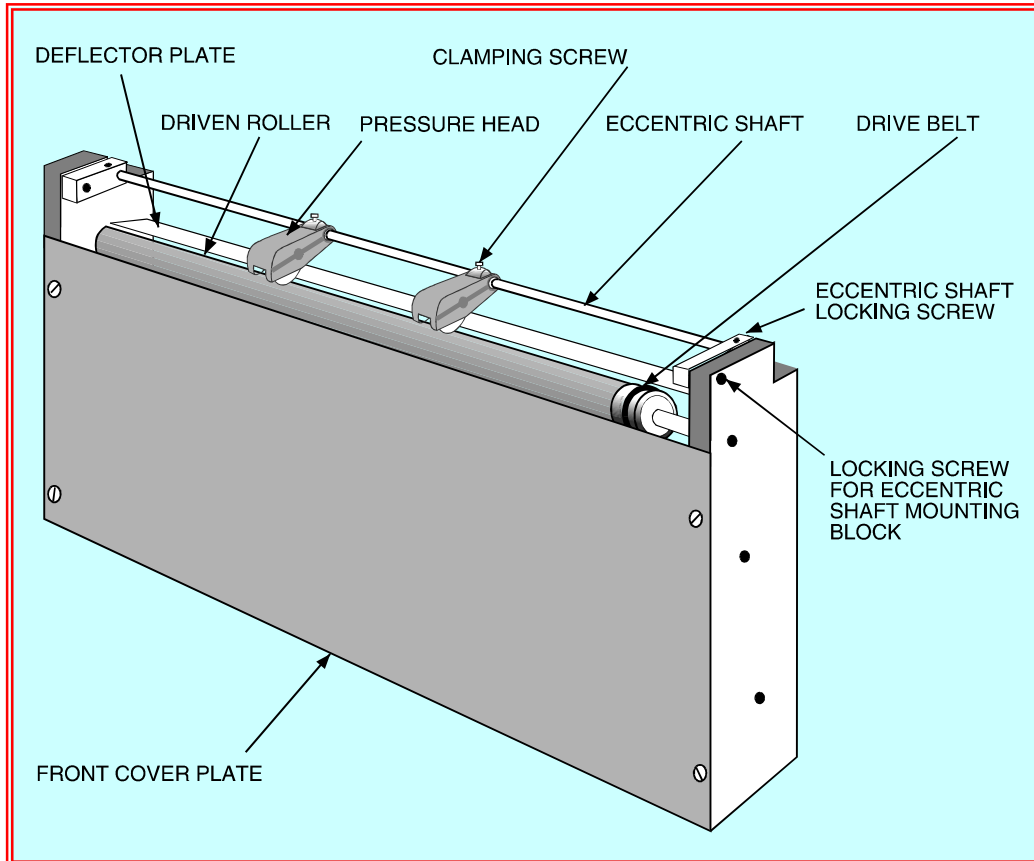

Fig 2.2 Identification of Main Parts

Two pressure heads are fitted above the roller, with their wheels running under pressure against the driven roller surface. This pressure can be altered by adjusting the spring tension in the pressure heads.

The two pressure heads are mounted on a shaft which has an eccentric centre. This can be rotated such that the shaft moves eccentrically, which in turn moves the pressure heads forwards or backwards around the surface of the driven roller. This changes the point of contact at which each head wheel touches the roller surface, so changing the angle at which the paper is ejected from the unit.

The pressure heads can also be moved laterally along the eccentric shaft to cater for different widths of paper.

Operation with an Ancillary Unit

The unit is supplied with mains power from the guillotine by interconnecting it with the mains lead supplied.

When fed from a guillotine, the outfeed accelerator unit accepts paper in whatever sequence has been set up at the ancillary unit and ejects it at an accelerated rate from the unit at whatever angle is required to match the surface of the subsequent ancillary equipment. It runs at a constant speed of 800 feet per minute.

INSTALLATION

- Position the outfeed accelerator unit so that its internal components are facing the guillotine. Align the 4 fixing holes on the side plate of the unit with those on the guillotine.
- Clamp the unit to the guillotine using the four M8 Allen bolts and washers from the fixing kit supplied.
- **WARNING:** Ensure that the guillotine is isolated from the local mains source before carrying out the next step.
- Connect the mains input cable supplied, to the outfeed accelerator unit and then to the mains output socket on the guillotine.
- Switch on the guillotine and check that the driven roller is rotating. Switch off the guillotine.
- The mains cable is supplied fitted with moulded connectors which should not normally require removal. However, should it become necessary to change either connector, the colour code is as follows:
 - Brown lead: Live
 - Blue lead: Neutral
 - Green/yellow: Earth (Ground).

OPERATING INSTRUCTIONS

- **WARNING:** Never operate the outfeed accelerator when wearing items of loose clothing or other decorative jewellery, such as necklaces or bracelets as they could become entrapped in the machinery and cause injury.
- Having set up the outfeed accelerator unit as in Installation above, adjust the pressure heads for paper width, angle of fire and pressure as shown on Fig 1.3.

OPERATIONAL MAINTENANCE

- **WARNING:** High voltage mains is present on this equipment. Ensure that the equipment is isolated from the mains supply when carrying out any maintenance procedures.
- The outfeed accelerator unit has been designed for low maintenance and service costs.
- **Cleaning:** This is limited to removing the build up of paper dust with an airline on a regular basis.
- **Lubrication:** No lubrication is necessary.

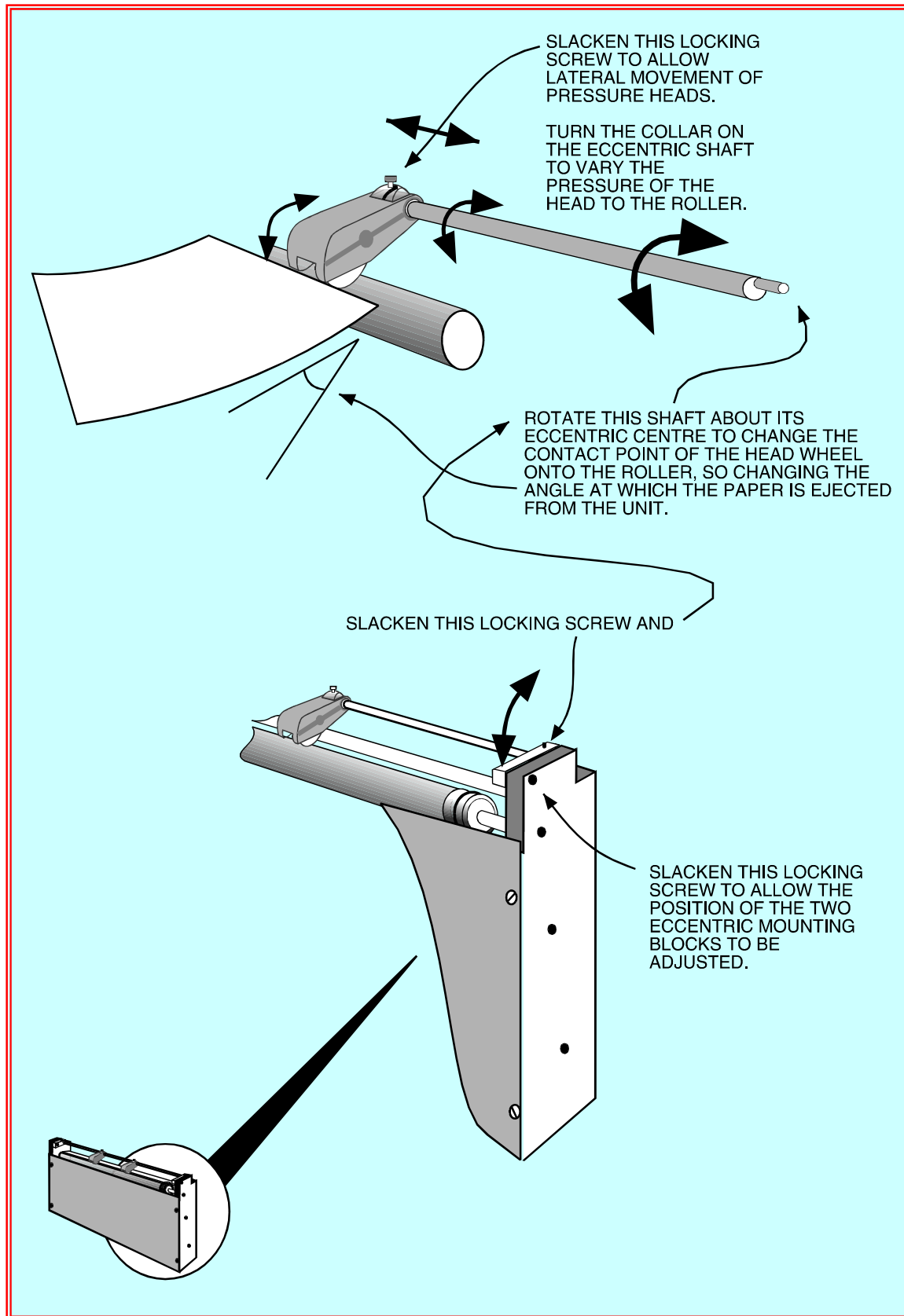

Fig 1.3 Operational Adjustments